

Progetto:  
- Ing. Matteo Torre  
- Ing. Emilio Sacco

PROGETTO ESECUTIVO  
RELATIVO AI LOTTI 5-6  
  
integrazioni nota 0018545/11

Calcoli Strati:  
- Ing. Alfonso Cristalli

TRAVI PIANO SECONDO

Collaboratore:  
- Geom. Salvatore Rubino

ELABORATO N°	SCALA	Il Responsabile del Procedimento:	
E S a.11	1/50	PE	

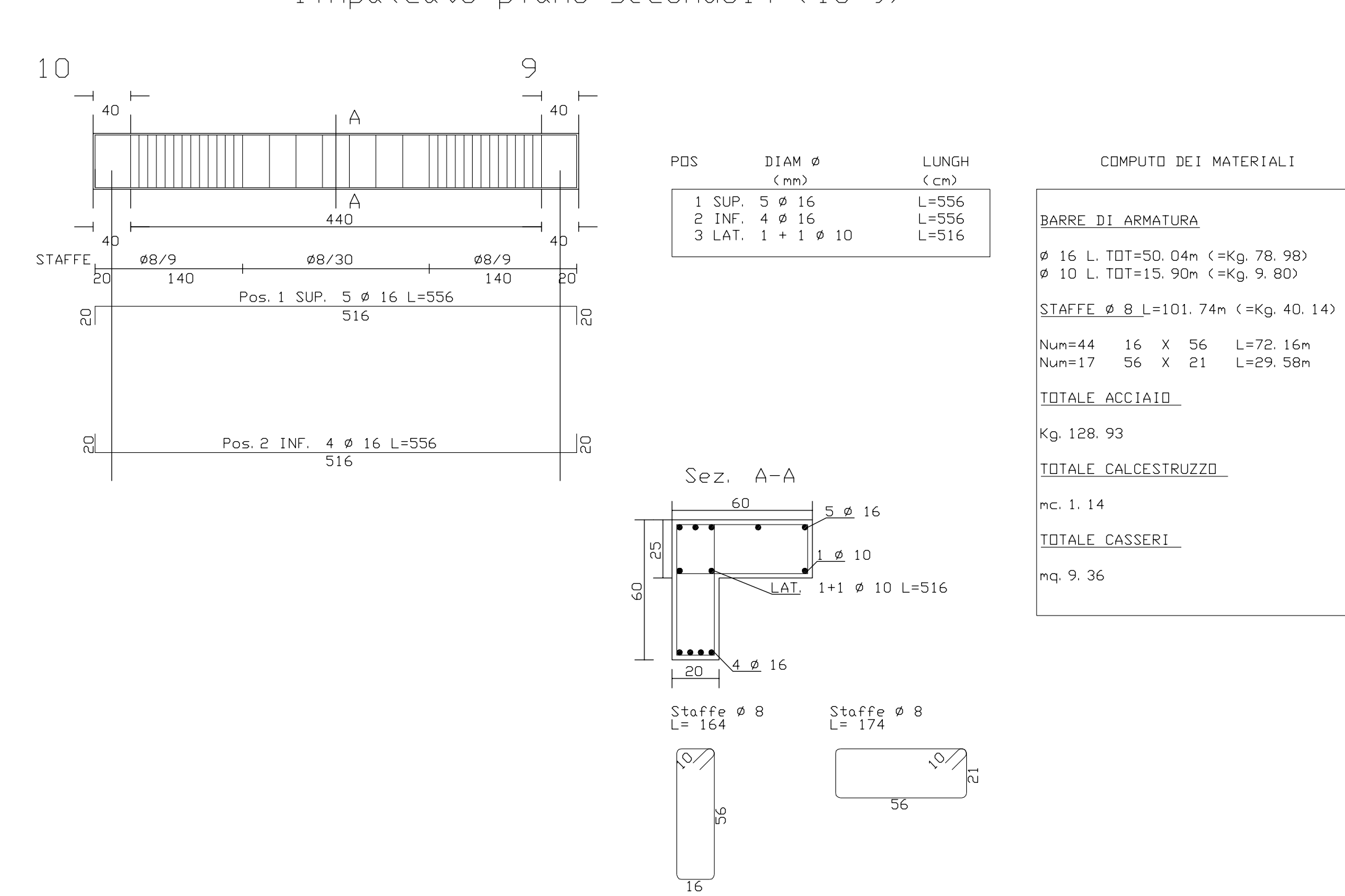
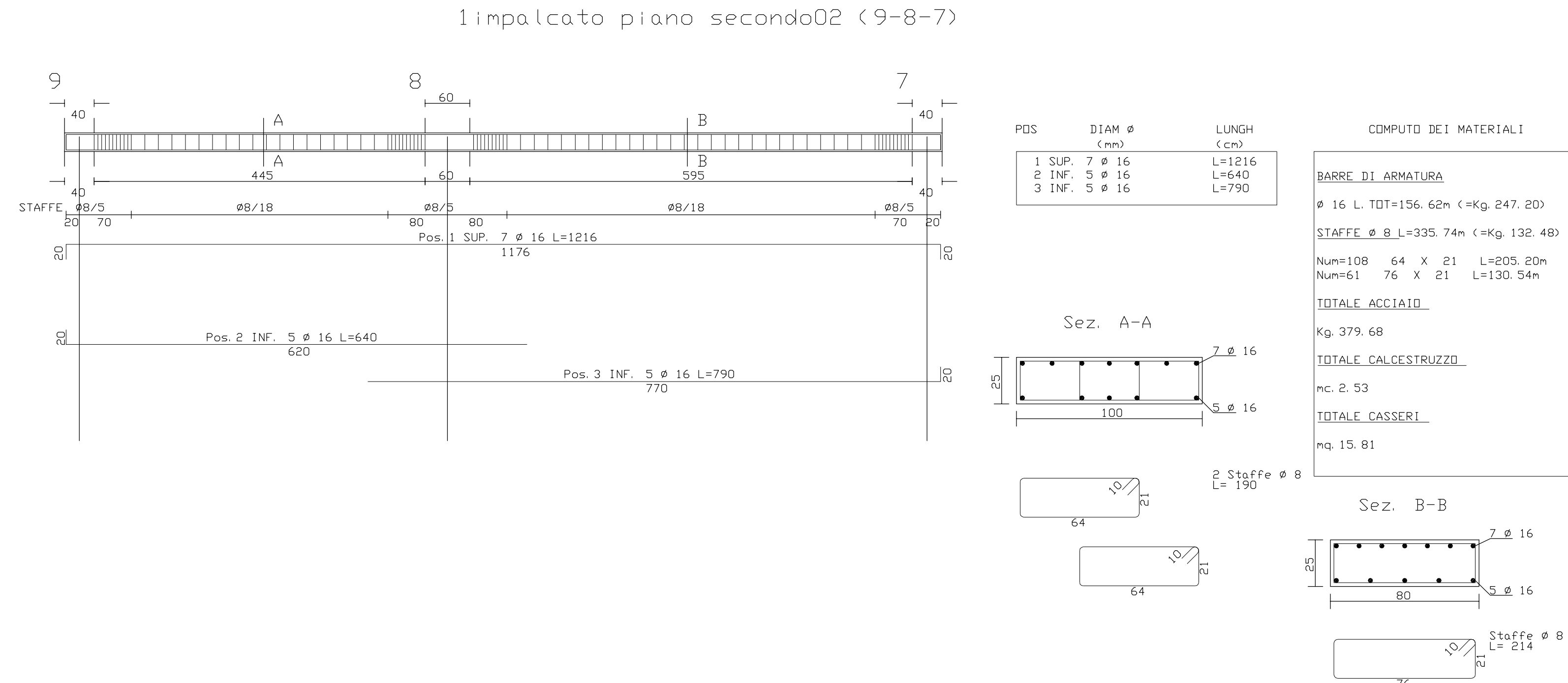
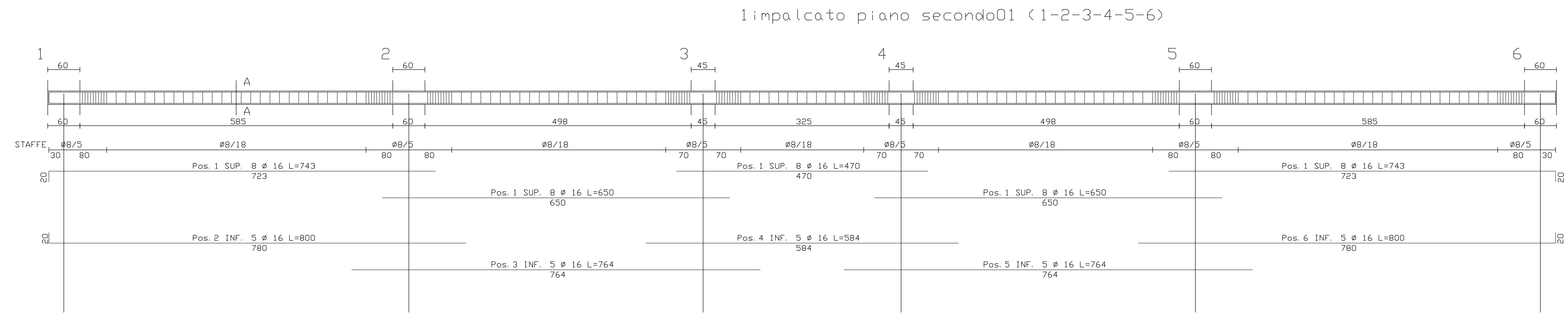

Impalcato piano secondo03 (12-11-10)

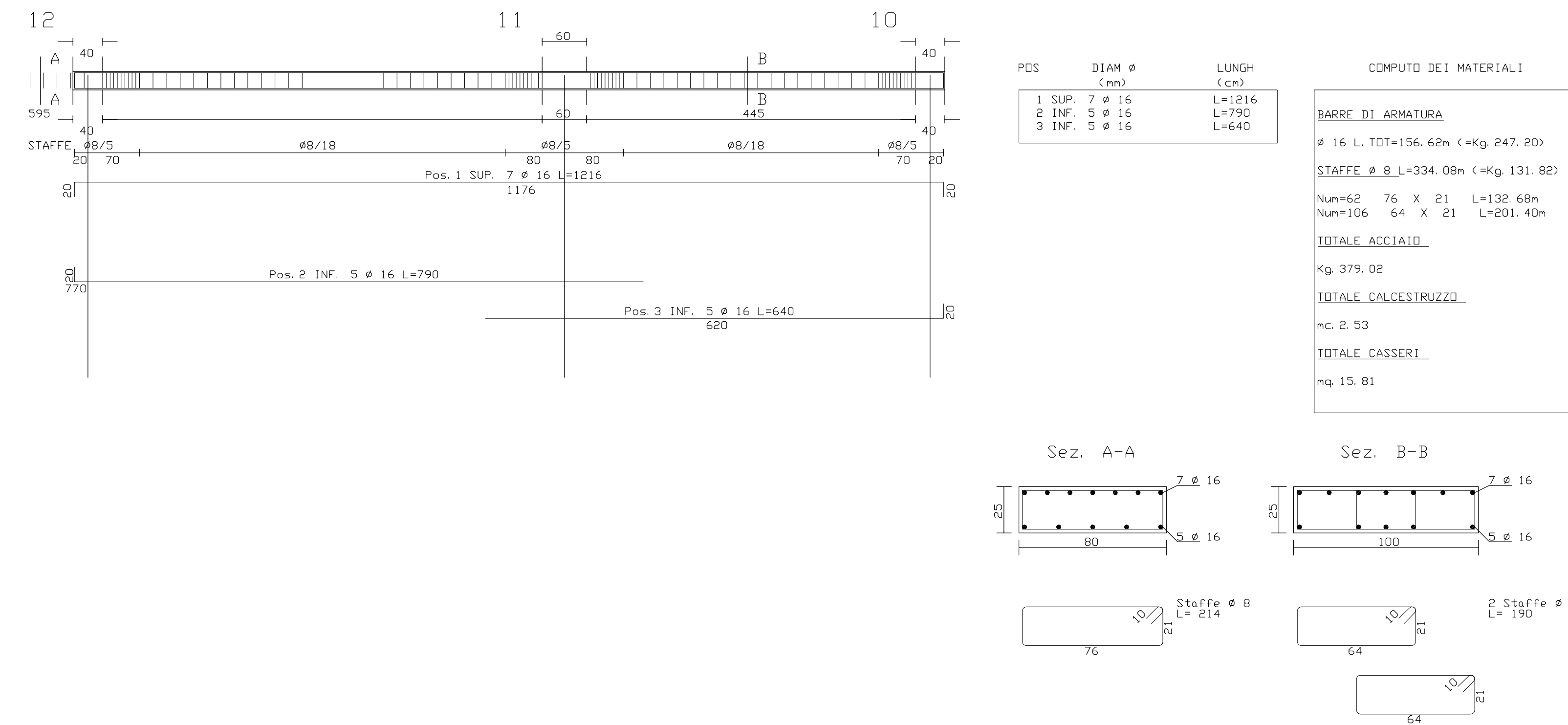

Impalcato piano secondo04 (15-14-13)

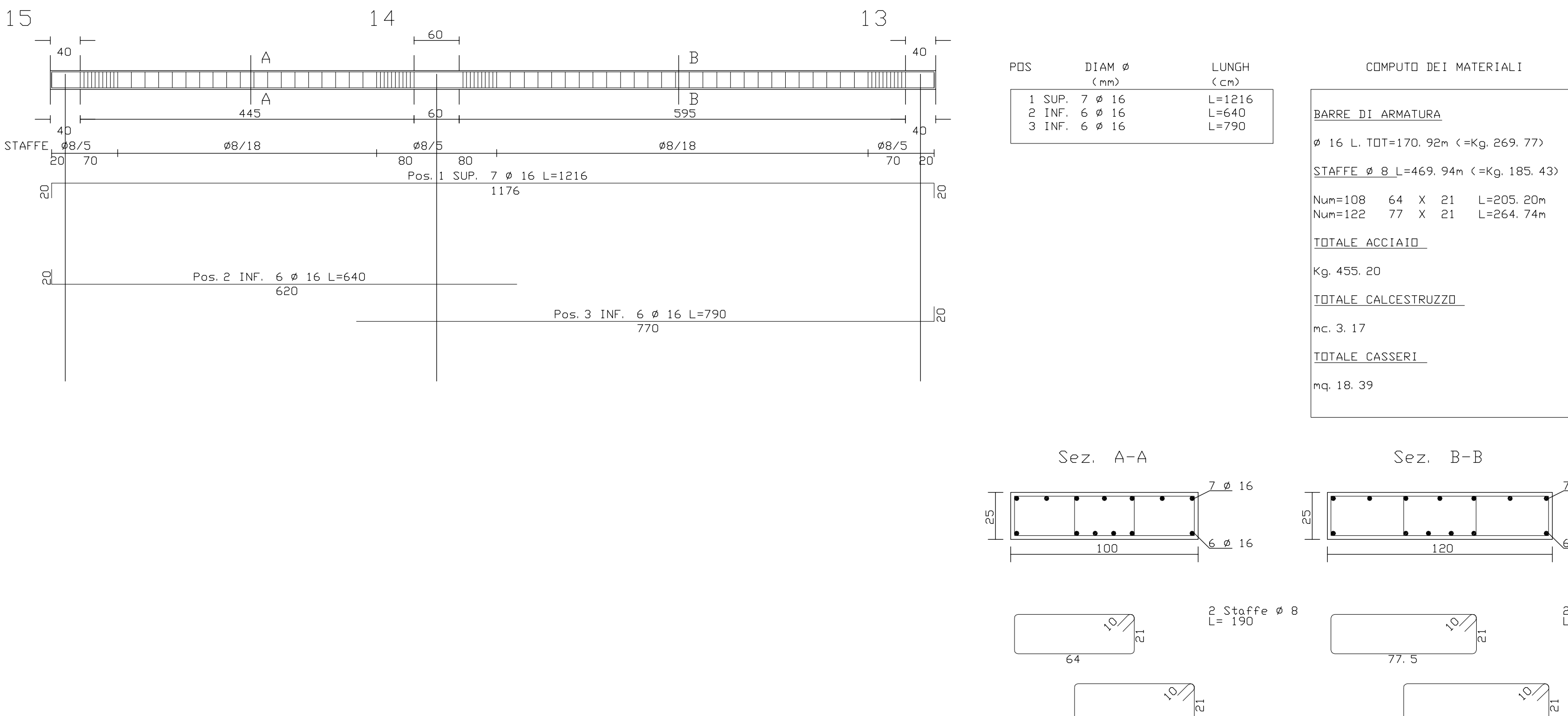

Impalcato piano secondo05 (18-17-16)

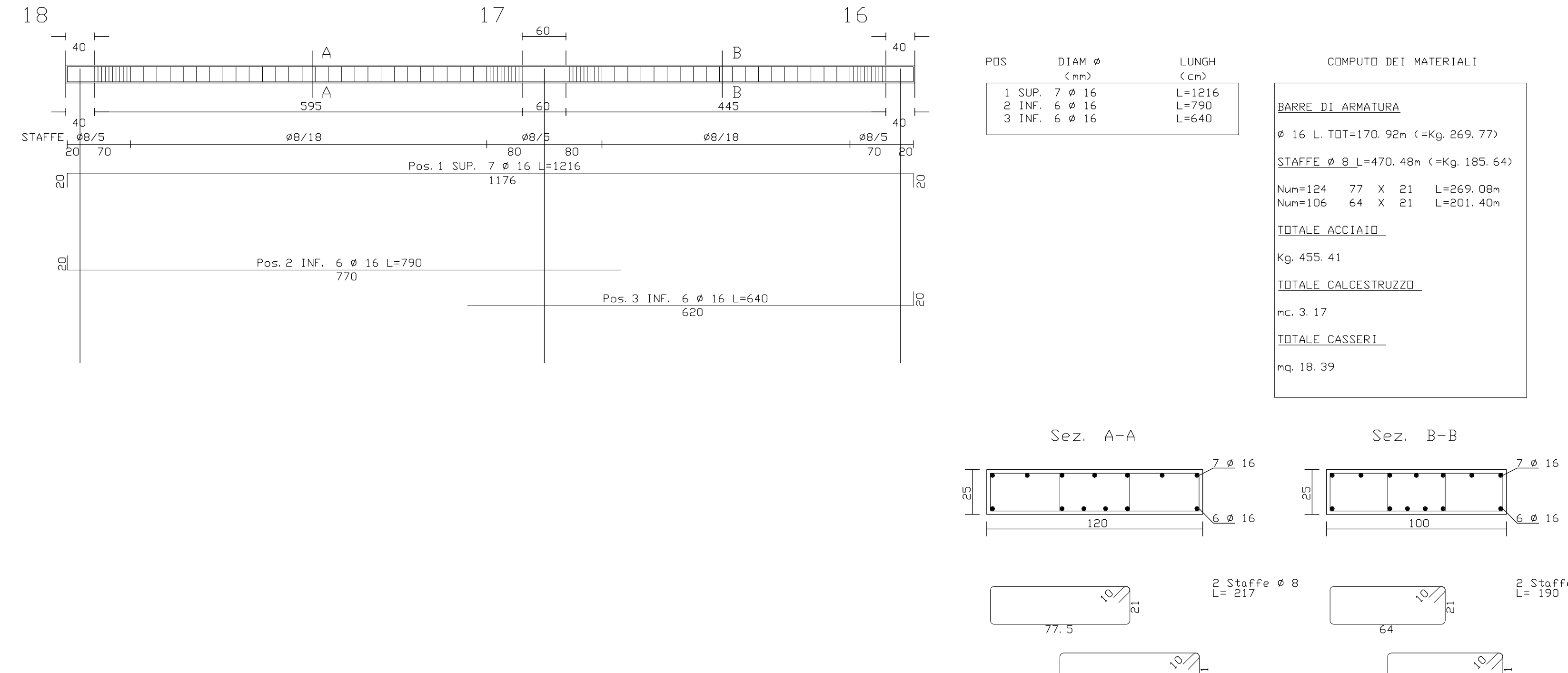

Impalcato piano secondo06 (13-7-1)

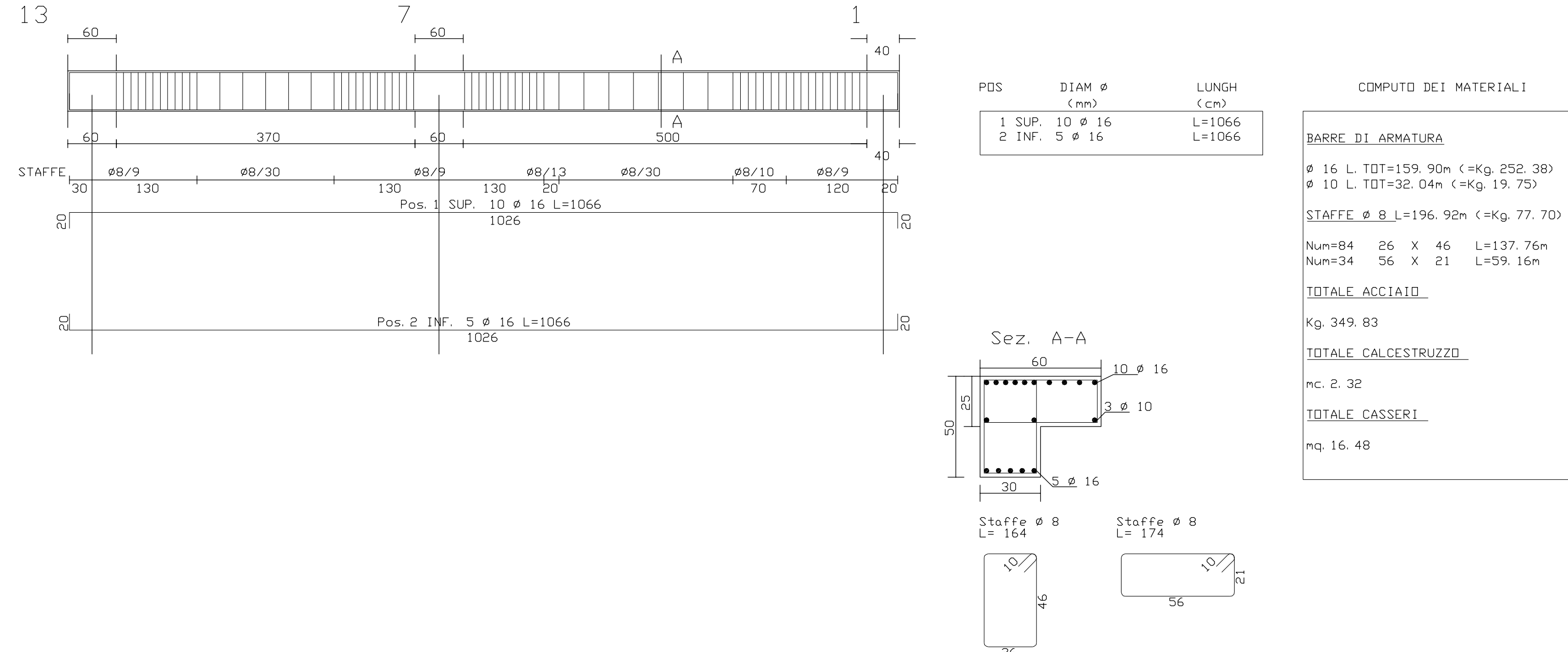

Impalcato piano secondo07 (14-8-2)

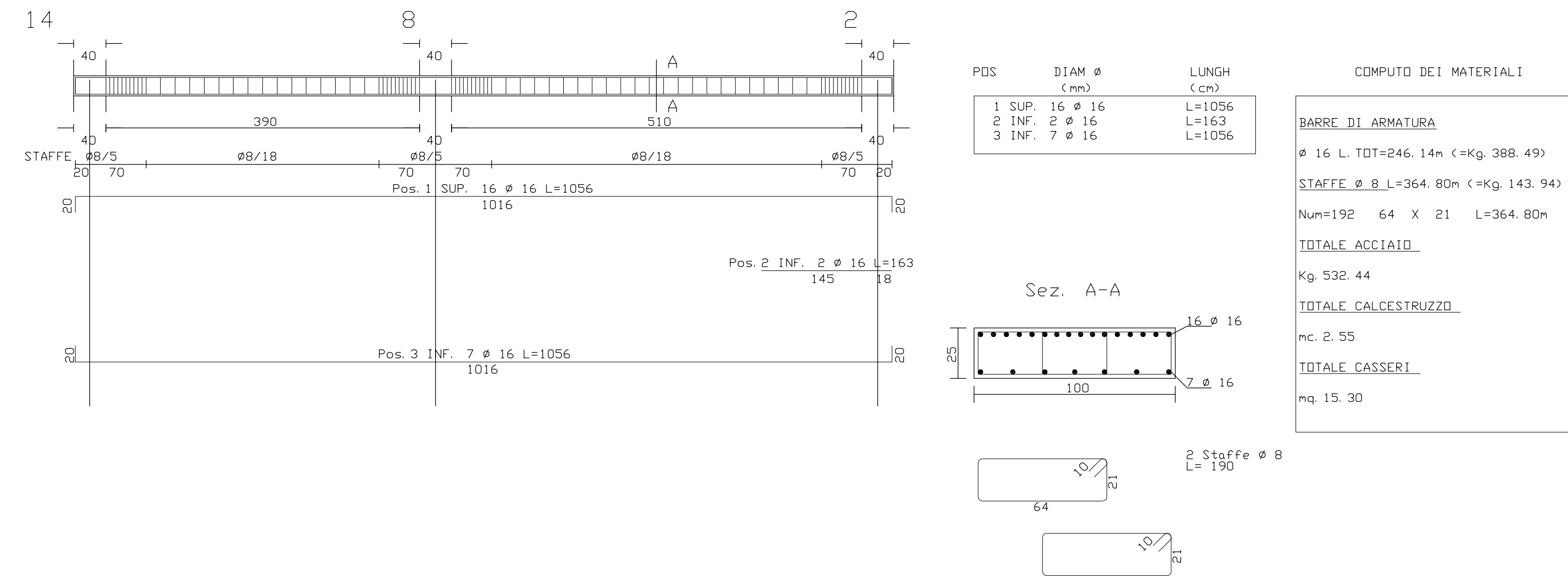

Impalcato piano secondo11 (9-3)

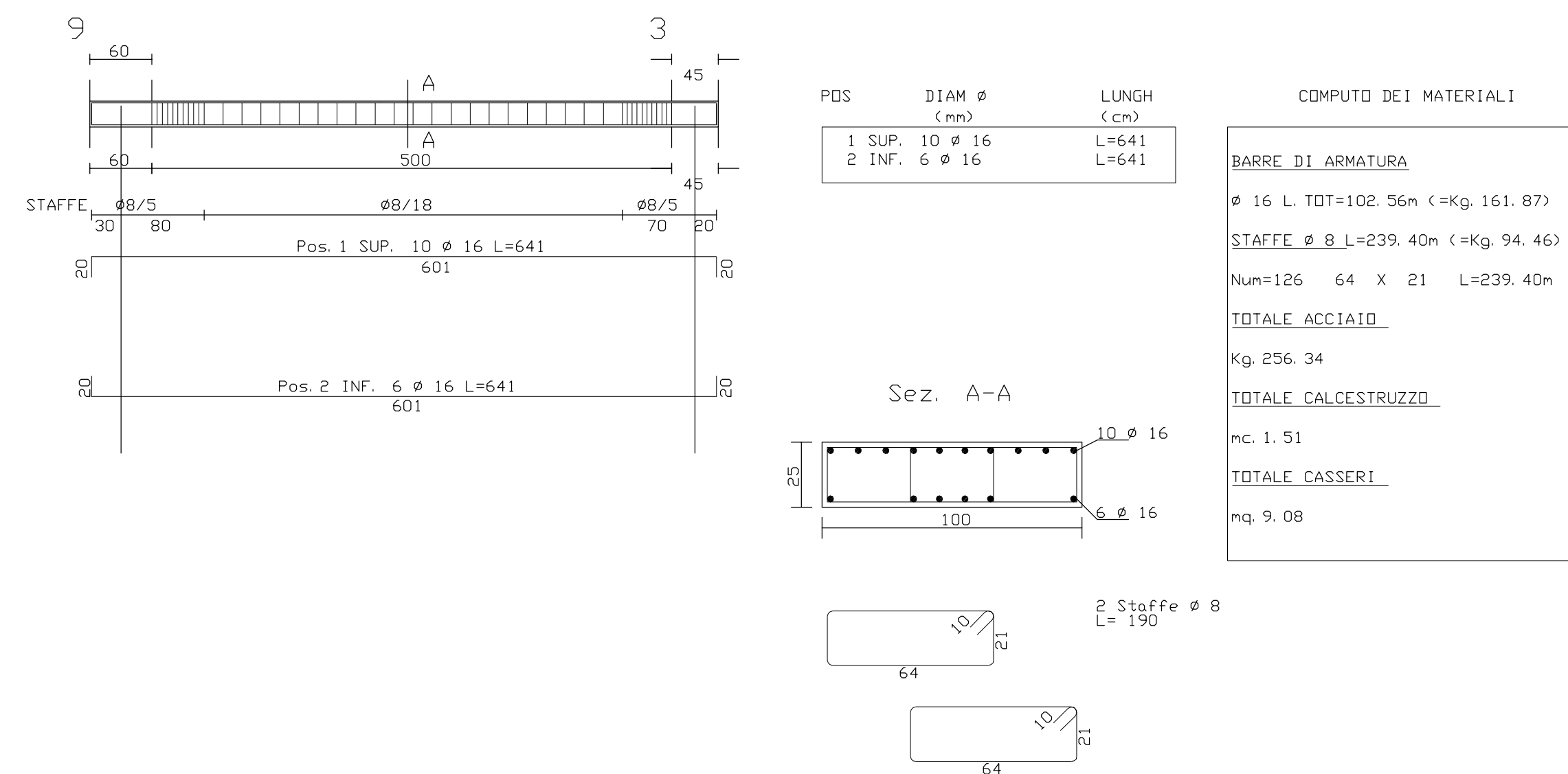

Impalcato piano secondo10 (15-9)

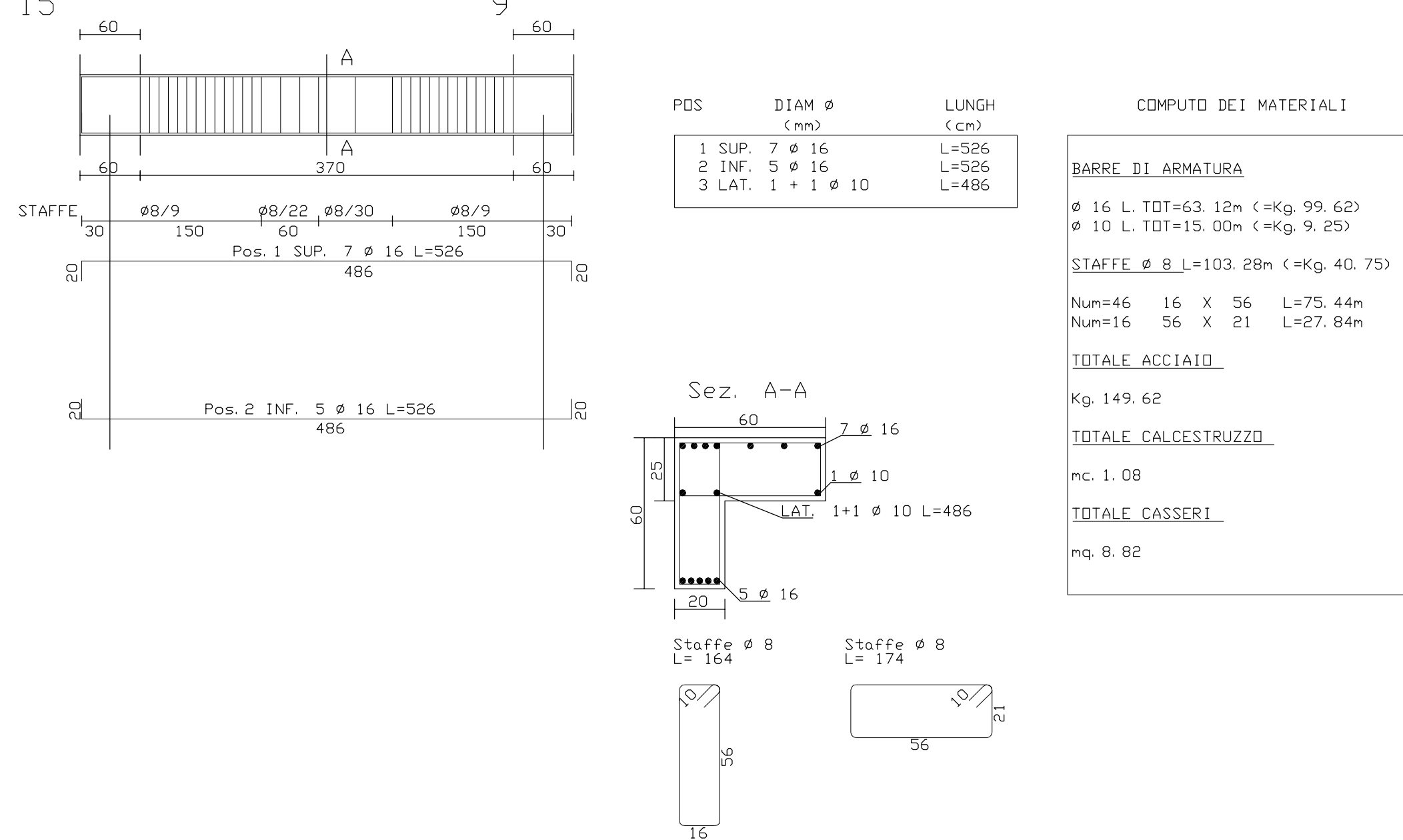

Impalcato piano secondo13 (10-4)

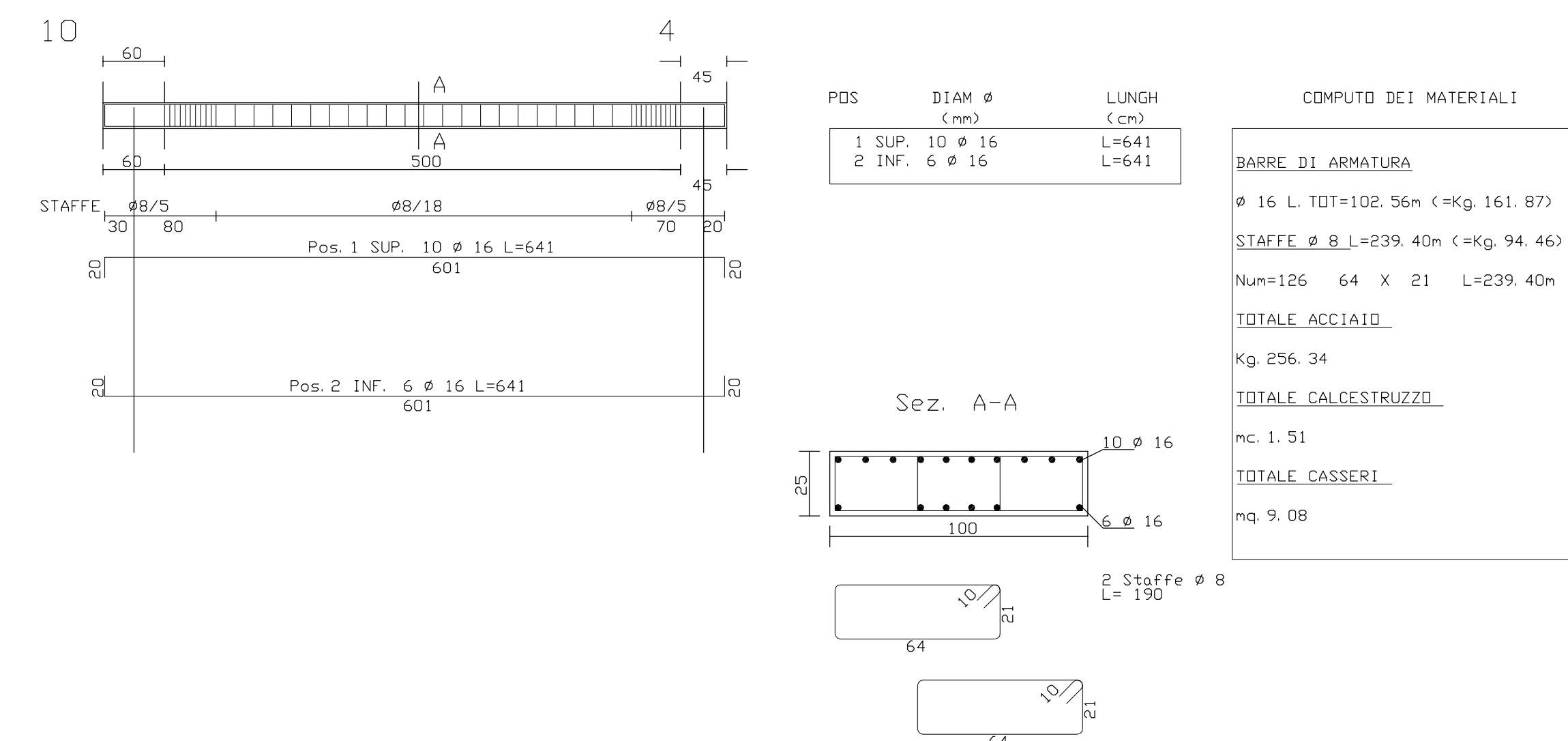

Impalcato piano secondo12 (16-10)

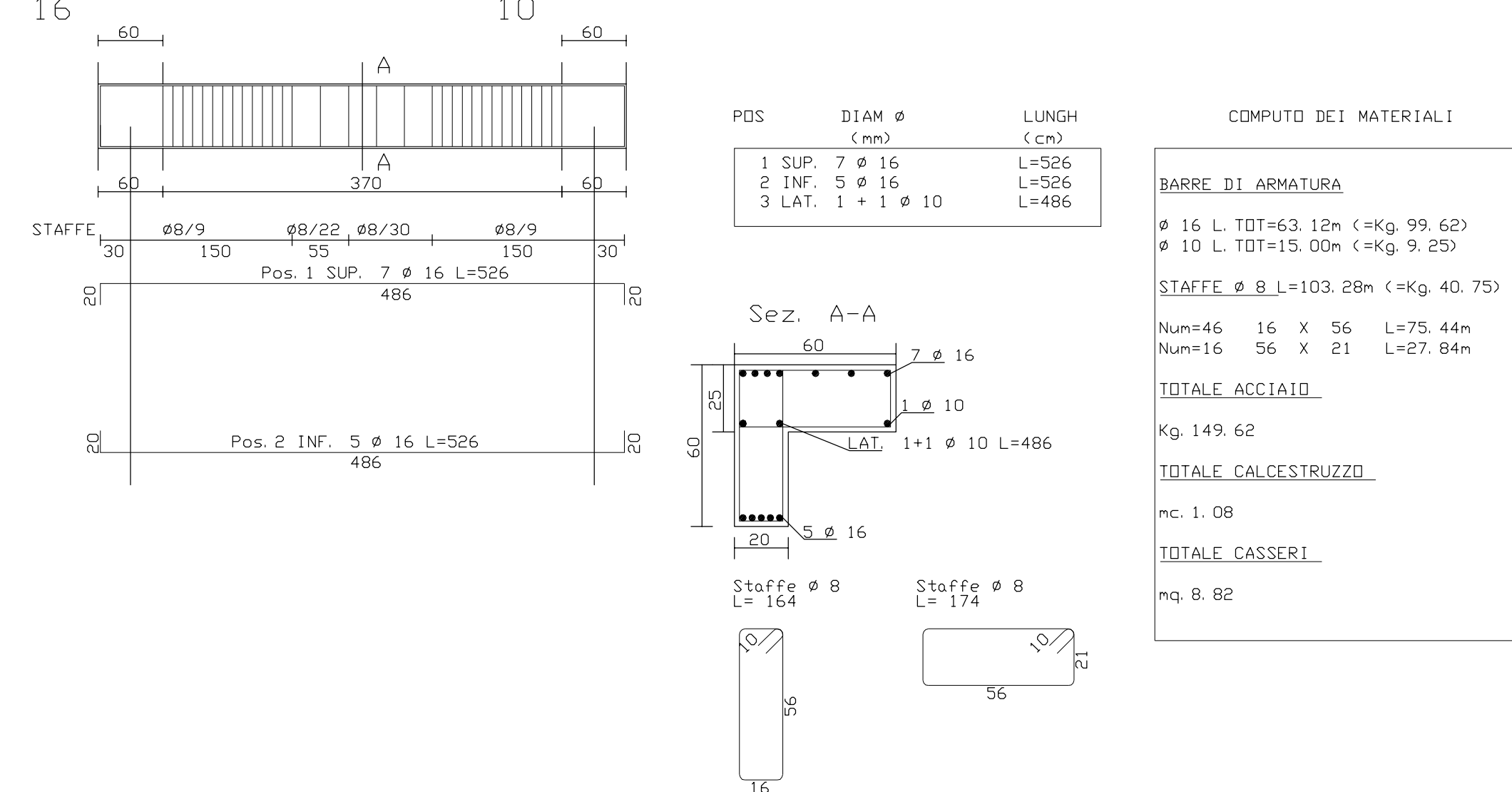

Impalcato piano secondo08 (17-11-5)

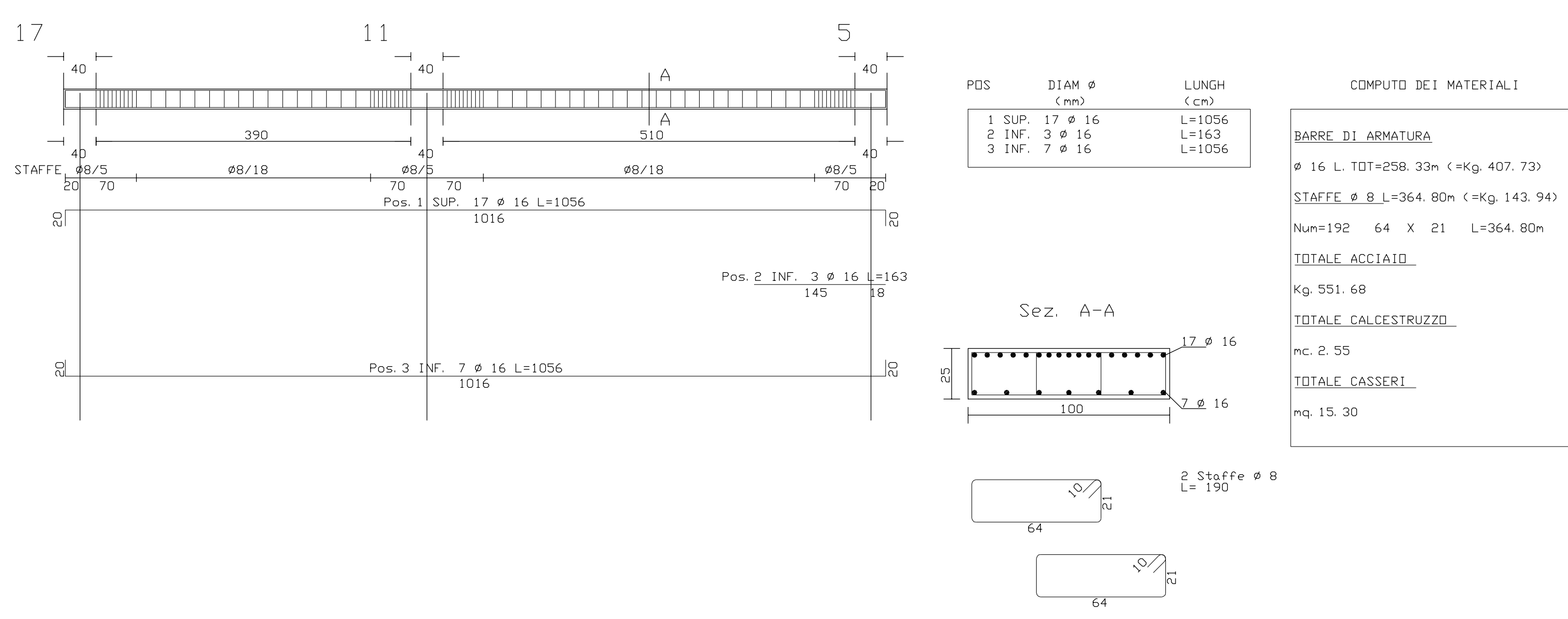

Impalcato piano secondo09 (18-12-6)

